

Assembly instruction

Part Number: RR73003530

Description: Roof bar kit e-Deliver 3, 3 bars



Revision date: 2025-04-08

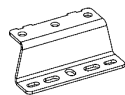

6x 27205-03

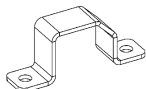

6x 27200-03



3x



2x



12x M8



24x M8x16



12x M8



12.5m



2x 37000

1

Clean rails and corresponding roof surface with Sika Cleaner P.



2

Prime rail and corresponding roof surface.
Wait 10 minutes for the primer to dry.



Primer Dry time (can be applied between 5° to 40°
Above 15° 10 min
Below 15° 30 min)

3

Apply the seal on the rails like in the images below.
Make a cut out for the vehicle beams.

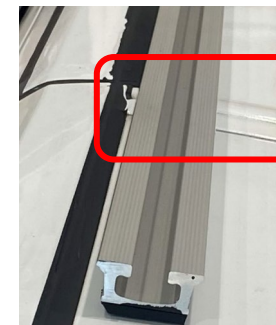

4

Apply glue (Sikaflex 668) to the first rail
and fit it to the section previously primed.
Repeat for the second rail.

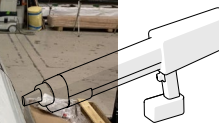
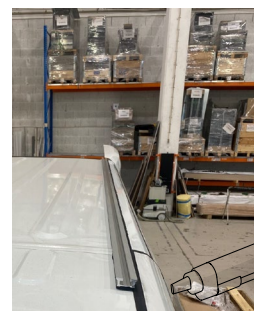

5

Mount the end caps on the front part of
the roof rails.



Sika Cleaner P
Art no: 39236

SAFETY GEAR



Primer 507
Art no: 39230-04



Primer Sponge
Art no: 39231

SAFETY GEAR



Glue gun
Art no: 39260



Glue Sikaflex 668
Art no: 39240-04



Glue nozzle
Art no: 39315

SAFETY GEAR



Assembly instruction

Part Number: RR73003530
Description: Roof bar kit e-Deliver 3, 3 bars



Revision date: 2025-04-08

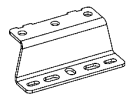

6x 27205-03

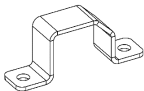

6x 27200-03



3x



2x



12x M8



24x M8x16



12x M8



12.5m



2x 37000

6



M8x16



M8



20Nm

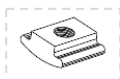
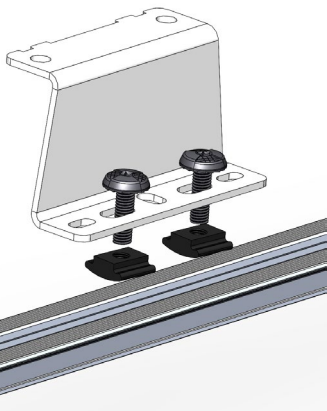

7



M8x16



M8

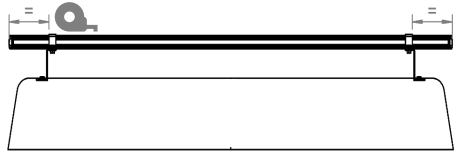
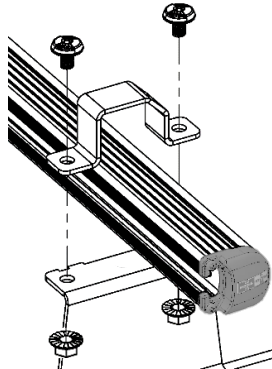

20Nm

